



What the Director of Education says about our school ... "I visited the school to see first-hand the fabulous work they do to include, to engage, and to help every child succeed. Cheadle Heath lives our Stockport Family values every day and at Cheadle Heath SEND is everyone's business." March 2023

26th January 2024

Issue 12



SEND HEADLINE

Latest news @ Cheadle Heath

What an amazing first three weeks back we have had at Cheadle Heath! It was another cold one last week but thank you for working with us to make sure this did not stop your children from coming into school. Research into primary school attendance has found setting good attendance patterns from an early age, from nursery through primary school can help your child later on in their life because children who have a poor school attendance record have less chance of securing a job when they are adults. #ontimealldayeveryday

From Rags 2 Riches

We have signed up to the Rags2Riches4Schools recycling scheme, to help others around the world benefit from our good quality unwanted clothes and shoes. Our collection is scheduled for **Thursday 7th February 2024** and bag(s) can be returned to the school from after school on Wednesday 6th February. You can help us to help others and raise funds for school. Even if it's only one t-shirt please bring it in, as it will all help. If you can, involve family, friends and neighbours. Thank you for your continuing support.

We've negotiated a deal!

Disappointed by the daily price increase in school meals, I have negotiated a lower price to £2.66 which is an increase of 12p as opposed to 24p with effect from 1st April 2024.

Reminders:

- Dolce only allow a pupil's account to fall into debt by three meals. This means that if school meals are in debt, a child will not be able to have a school meal until the debt is cleared and a packed lunch will have to be brought into school.
- Please pre-order school meals to ensure your child has a meal they enjoy at lunchtime. If you pre-order and they arrive to school late they will still be guaranteed their choice. You can pre-order daily, weekly or half termly from home. Need help ordering? Ask us!
- Are you (or could you be) eligible for free school meals? [Click here](#) to check eligibility criteria & apply or contact SBM Mrs Topping who can check for you.

Gate Opening Reminder!

The gates are opened at 8.40am and locked at 8.50am. Registration takes place between 8.50am and 8.55am, allowing lessons to start promptly at 9am. We have had some complaints that gates are being locked early at 8.50am - this is not the case. If you arrive after 8.50am, you will need to sign your child in using the signing in system in the school entrance. We keep a record of all late comers and those who are persistently late will be followed up by myself and the Education Welfare Team.

Cheadle Heath Primary School

What the Director of Education says about our school ... "I visited the school to see first-hand the fabulous work they do to include, to engage, and to help every child succeed. Cheadle Heath lives our Stockport Family values every day and at Cheadle Heath SEND is everyone's business." March 2023

Outdoor area is go, go, go!

We are excited to announce that we have a starting date for our new EYFS outdoor area, phase 1 of our grounds development, 1st April! We have already raised a significant amount of money but there is still a long way to go to cover the £96k cost!

Exciting Times ...

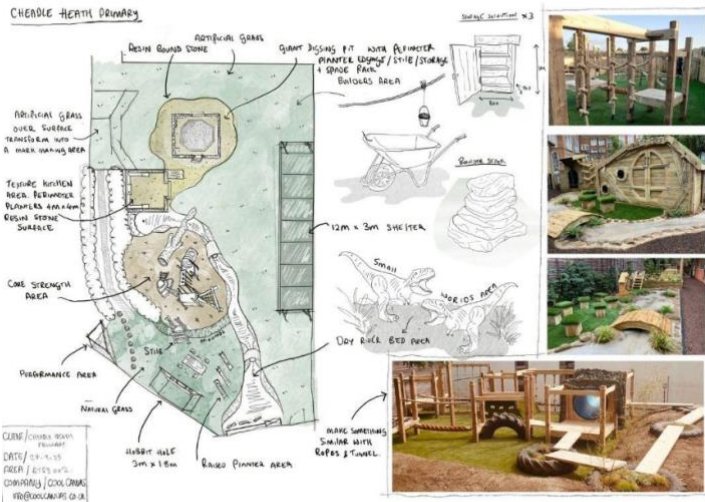

... new outdoor area!

Last year we developed an onsite orienteering course, which is used by all year groups. This development includes a new EYFS outdoor classroom and enhancement of the forest school area to incorporate a seating circle, willow tunnels, wildlife garden and mud kitchen so we have set up a Go Fund Me fundraising page to help us raise funds. If you want to help us to raise funds to enrich our children's learning experience and continue to build our school community please follow the link below.

<https://www.gofundme.com/f/cheadleheathoutdoor>



If you have any comments or queries you can contact the school office on 428 2476 or email admin@cheadleheathprimary.co.uk

Family Night ... 02.02.24



Nursery places available for September 2024

There is still time - until 31st March 2024 - to apply for a Nursery place for your child at Cheadle Heath Primary School. If your child was born between 1st September 2020 to 31st August 2021, please [APPLY HERE](#). We will be able offer a limited number of 30 hour places for eligible families. These are allocated on a first come, first serve basis. If you require, and are eligible for, a 30 hour place you must provide your 30 hour code with your application form. To find out more about childcare options available to you please visit Stockport's Family Information Service.

Save the dates!

- We've booked next year's panto to see the 10.30am showing of Sleeping Beauty at Stockport Plaza on Tuesday 10th December 2024. This is for Y2 – Y6 as we will take Reception & Y1 to a shorter festive show.
- Y6 will be participating in the North West Children's Shakespeare Festival and will be working alongside other schools to perform on stage at The Lowry on Thursday 18th July. Y6 teacher Miss Campbell has been on a two-day residential to live and learn the script (which is still under wraps!) and start planning for what will be an awesome experience for all.
- Calling Y5 ... the Y6 residential is 16th – 18th October 2024. Sign up now!

Cheadle Heath Primary School

What the Director of Education says about our school ... "I visited the school to see first-hand the fabulous work they do to include, to engage, and to help every child succeed. Cheadle Heath lives our Stockport Family values every day and at Cheadle Heath SEND is everyone's business." March 2023

Starting soon ... Cricket Club

For five weeks only, we will be offering FREE cricket club to anyone in Years 3 - 6 after school on a Friday. This will start after February half term until Easter. Places are limited to 25 and we must have 20 for it to proceed so watch out for more information and a signing up link.

Moments Matter, Attendance Counts!

Attendance remains a huge focus for us this term and we will be working hard with families to support them where necessary. Regular attendance and good punctuality are crucial factors in students achieving their full potential. We are committed to providing a full education to all, and encouraging our pupils to strive for excellence. We work in partnership with families and so are seeking your full support in ensuring that your child attends school every day and on time.

We are always pleased to work together with you in resolving any difficulties, but we are also committed to improving attendance levels. The target attendance figure this term for all is a minimum of 97% attendance.

To support excellent attendance, we ask everyone to:

- Ensure your child attends every day, on time. Registration starts at 8.50am.
- Contact the school every day your child is absent if they are ill and give a medical reason for their absence: do not just say unwell
- Ensure that medical appointments are made outside of school time wherever possible
- Ensure that if medical appointments are inside of school time you do not keep your child off school all day
- Ensure that holidays should not be taken in school time. Holidays will not be authorised during term time
- Contact your child's class teacher phase leader if you are experiencing difficulty in getting your them into the school and we will support to help resolve any issues

Please remember we will be sending out formal letters more this year as part of the LA approach to managing attendance. If you would like to discuss this or any matter regarding attendance please message Mrs Steele, our Attendance Officer.

Need half term child care?



ESC SCHOOLS

FEBRUARY HOLIDAY CAMP

PE & Sports Specialist's Delivering for over 10 years in Greater Manchester

Activities

- ✓ NERF Games
- ✓ Bowling
- ✓ Puck Hockey
- ✓ Football
- ✓ Dodgeball
- ✓ Basketball
- ✓ Table Tennis
- ✓ Arts & Crafts
- ✓ And Many More...

Per Day **£21** Per Week **£84**

MONDAY 12TH - THURSDAY 15TH FEBRUARY



Meadowbank Primary School
Councillor Lane
Cheadle, SK8 2LE

Registration Link
<https://esc-schools.classforkids.io/camps>

GET IN TOUCH 07709182699 info@esc-schools.co.uk



Stockport County FC Community Trust

COUNTY CAMPS

County football training holiday camps are back!
For both boys & girls aged 5 - 12 years old.



Tuesday 13th, Wednesday 14th & Thursday 15th February, 10am - 3pm | £30 per day or £75 three day offer

What's on offer - fun training sessions lead by qualified coaches, visit from Stockport County players and fun competitions.
Where - Cheadle Heath Nomads, Norbreck Avenue, Cheadle, SK8 2ET

Limited Availability - Sign up now to secure your child's spot! Scan the above QR code to sign up

Have a great weekend & stay warm
Christine Meekley & the staff at #teamCHPS

Cheadle Heath Primary School

What the Director of Education says about our school ... "I visited the school to see first-hand the fabulous work they do to include, to engage, and to help every child succeed. Cheadle Heath lives our Stockport Family values every day and at Cheadle Heath SEND is everyone's business." March 2023

Key Dates for Spring Term 2024: Monday 8th January – Thursday 28th March

Monday 29 th January	Y6 pupils to Chill Factor ^e (letters have been distributed to those selected)
Wednesday 31 st January	Y5 girls to Stockport Academy for MUFC community football session (until Easter) Full Governing Board Meeting 3/6
Friday 2 nd February	Family Night with Chris Mitchell 6.30 – 8.30pm
w/b Monday 5 th February	Stay & Learn Computing with Me – times to be arranged by individual class teachers
Tuesday 6 th February	Big Computing Day led by Mrs Mason-Singh
Wednesday 7 th February	Rags2Riches clothes collection
Thursday 8 th February	Y6 to Chester Zoo
Half Term Holidays: Monday 12 th February – Friday 16 th February 2024	
Monday 19 th February	INSET 3 / 5 – Staff only in school
Tuesday 20 th February	EYFS Stay & Play – Reception 8.45 – 9.45am / Nursery 2.15pm – 3.15pm
Thursday 21 st March	Big RE Day Y3/4 to All Hallows Church to the Easter Trail
Friday 23 rd February	KS2 after school FREE cricket club starts (until Easter)
Monday 26 th February	Dodgeball team in the Stockport Borough finals
Tuesday 27 th February	Y5 visit to Jodrell Bank Reception – Mini athletics festival in school @ 1.30pm
Thursday 29 th February	UKS2 football tournament at Stockport Academy
Tuesday 5 th March	KS2 SATs meeting for Y6 parents 5pm
Thursday 7 th March	World Book Day World Book Day Immersive Storytelling with Miss Shelmerdine
Friday 8 th March	U11s Y6 footballers @ Manchester City Football Academy Festival
w/b Monday 11 th March	Science Week: Time! There will science themed nights at Sunset Club this week so book your places early
Tuesday 12 th March	Stay & Learn Science with Me – times to be arranged by individual class teachers
Thursday 14 th March	Parks Class (Y3/4) netball match v Lark Hill Primary D-I-S-C-O fever time again
Tuesday 19 th March	KS2 Netball festival at Stockport Academy 3.45 – 5.15pm
Wednesday 20 th March	Y5 to Cheadle Hulme School – Music Outreach Concert
Thursday 21 st March	Big RE Day Y3/4 to All Hallows Church for the Easter Storytrail
Tuesday 26 th March	Parents' Evening until 6pm
Wednesday 27 th March	Parents' Evening until 6pm
Thursday 28 th March	EYFS & KS1 Easter Bonnet Parade – 2.15pm in the playground End of the Spring term. School closes at 3.15pm for the Easter Holidays. Full Governing Board Meeting 4/6 at 4pm
Easter Holidays: Friday 29 th March – Friday 12 th April 2024	
Monday 15 th April	Peter Kennedy Shakespeare launch with Y6
Tuesday 16 th April	EYFS Stay & Play – Reception 8.45 – 9.45am / Nursery 2.15pm – 3.15pm
Wednesday 17 th April	LKS2 Football @ Stockport Academy
Friday 19 th April	KS2 Cross Country 3.45pm
Tuesday 23 rd April	Y5 to CHS to watch The Little Mermaid production
Wednesday 24 th April	Class photos
Tuesday 30 th April	Nursery – Mini athletics festival in school @ 1.30pm
Monday 6 th May	Bank Holiday Monday – school closed
Wednesday 8 th May	Stay & Read – come into the classroom and read with your child 8.45 – 9.15am
Thursday 9 th May	Stay & Read – come into the classroom and read with your child 8.45 – 9.15am
Friday 10 th May	Stay & Read – come into the classroom and read with your child 8.45 – 9.15am
w/b Monday 13 th May	Year 6 SATs
Wednesday 15 th May	Reception Height & Weight checks Full Governing Board Meeting 5/6 at 4pm
Thursday 16 th May	Y3 football match – Lark Hill v Cheadle Heath
Friday 17 th May	UKS2 rounders match @ Cheadle Heath
Friday 24 th May	School Closes for Whit

Cheadle Heath Primary School

What the Director of Education says about our school ... "I visited the school to see first-hand the fabulous work they do to include, to engage, and to help every child succeed. Cheadle Heath lives our Stockport Family values every day and at Cheadle Heath SEND is everyone's business." March 2023

Term dates 2023 – 24

	School starts on the morning of:	School finishes at the end of the day on:
Autumn 1	Tuesday 5 th September 2023	Friday 20 th October 2023
Autumn 2	Monday 30 th October 2023	Thursday 21 st December 2023
Spring 1	Monday 8 th January 2024	Friday 9 th February 2024
Spring 2	Tuesday 20 th February 2024	Thursday 28 th March 2024
Summer 1	Monday 15 th April 2024	Friday 24 th May 2024
Summer 2	Monday 10 th June 2024	Friday 26 th July 2024
INSET days Staff only in attendance	<ol style="list-style-type: none"> Monday 4th September 2023 Friday 22nd December 2023 Monday 19th February 2024 Monday 29th July 2024 Tuesday 30th July 2024 	

Term dates 2024 – 25

	School starts on the morning of:	School finishes at the end of the day on:
Autumn 1	Tuesday 3 rd September 2024	Friday 18 th October 2024
Autumn 2	Tuesday 29 th October 2024	Thursday 19 th December 2024
Spring 1	Monday 6 th January 2025	Friday 14 th February 2025
Spring 2	Tuesday 25 th February 2025	Friday 11 th April 2025
Summer 1	Monday 28 th April 2025	Friday 23 rd May 2025
Summer 2	Monday 9 th June 2025	Friday 25 th July 2025
INSET days Staff only in attendance	<ol style="list-style-type: none"> Monday 2nd September 2024 Monday 28th October 2024 Thursday 2nd January 2025 Friday 3rd January 2025 Monday 24th February 2025 	